

## TECHNICAL SHEET 05.06.13-EN

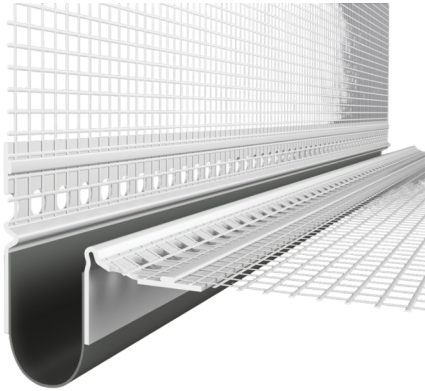

# JUBIZOL Movement joint bead V

## Movement joint bead for corner areas

### 1. Description, usability

JUBIZOL DILATACIJSKI PROFIL V 2,5 M with reinforcement mesh is used for creating visible expansion joints on flat facade surfaces in thermal insulation systems such as JUBIZOL. It can be used in new constructions as well as in thermal renovations of facades of old buildings.

Features:

- Longitudinal joining of two profiles is made possible with adhesive tape for easy and reliable connection of individual slats
- High-quality surface integration without the risk of cracks
- Protection of expansion joints from weather influences
- Prevention of moisture penetration under the insulation layer
- Invisible edges, slat under the plaster

### 2. Packaging

- JUBIZOL DILATACIJSKI PROFIL V 2,5 M (slat 2.5 m, package 62.5 m)

### 3. Technical data

Product name	JUBIZOL DILATACIJSKI PROFIL V 2,5 M
Material	PVC, resistant to alkaline fileds Thermoplastic elastomer Glass fiber mesh in accordance with ETAG 004
Batten lenght	2500 mm
Mesh width	100mm x 100mm
Rubber strip lenght	55 mm
Expansion range (±)	15 mm

Joint width	15 mm - 20 mm
Mesh attachment method	Welding

## 4. Installation

At the intended location where the expansion joint will take place on the facade, leave a gap of approximately 2 cm in the thermal insulation layer. Fill the prepared joint with pieces or cut-offs of the used thermal insulation to the depth of the expansion profile. This prevents the formation of a thermal bridge. Install the expansion joint profile by pressing the arms of the profile into a thin layer of adhesive mortar, which is applied in appropriately wide strips to the thermal insulation layer on both sides of the expansion joint using a notched steel trowel. Align it using a water scale. To achieve an exact width of the expansion joint along the entire length of the profile, insert pre-cut strips of polystyrene into the joint on the outside of the profile. The adhesive mortar that squeezes through the reinforcement mesh should be »stretched« out as much as possible, and any excess mortar should be removed. Remove the polystyrene strips that maintained the uniform gap of the profile after the mortar has dried. The exact location, width, and length of the expansion joint on the facade are usually determined by the project's designer. Unless specified otherwise, the recommended width of the joint is between 15 and 20 mm.

For the display of movement joint bead, see picture 001 in the appendix.

## 5. Instructions for safe use of the product

Safety handling instructions, first aid measures, fire protection measures, measures in case of accidental releases, special storage instructions, required personal protective equipment, waste handling instructions, special transport requirements, and other legally prescribed information are provided in the product's safety data sheet. In addition to these instructions, it is necessary to follow the guidelines and regulations for safety in construction, facade work, and painting when installing the product.

## 6. Storage, transportation conditions and durability

Packed in cardboard boxes. Store in a dry and covered area at a temperature of +5°C to +40°C. Transport in a horizontal position. Shelf life when stored in the original sealed and undamaged packaging: at least months.

## 7. Other information

The technical instructions in this brochure are provided on the basis of JUB's experience and are given as a guideline for achieving the optimum results. JUB cannot accept any responsibility for the damage caused by incorrect selection of a product, incorrect use or unprofessional work.

Safety measures: Follow the instructions on the safety data sheet of the product.

This technical sheet supplements and replaces all preceding editions. JUB reserves the right to change and supplement data in the future.

Designation and date of issue: TDS 121/25-pek, 15.12.2025

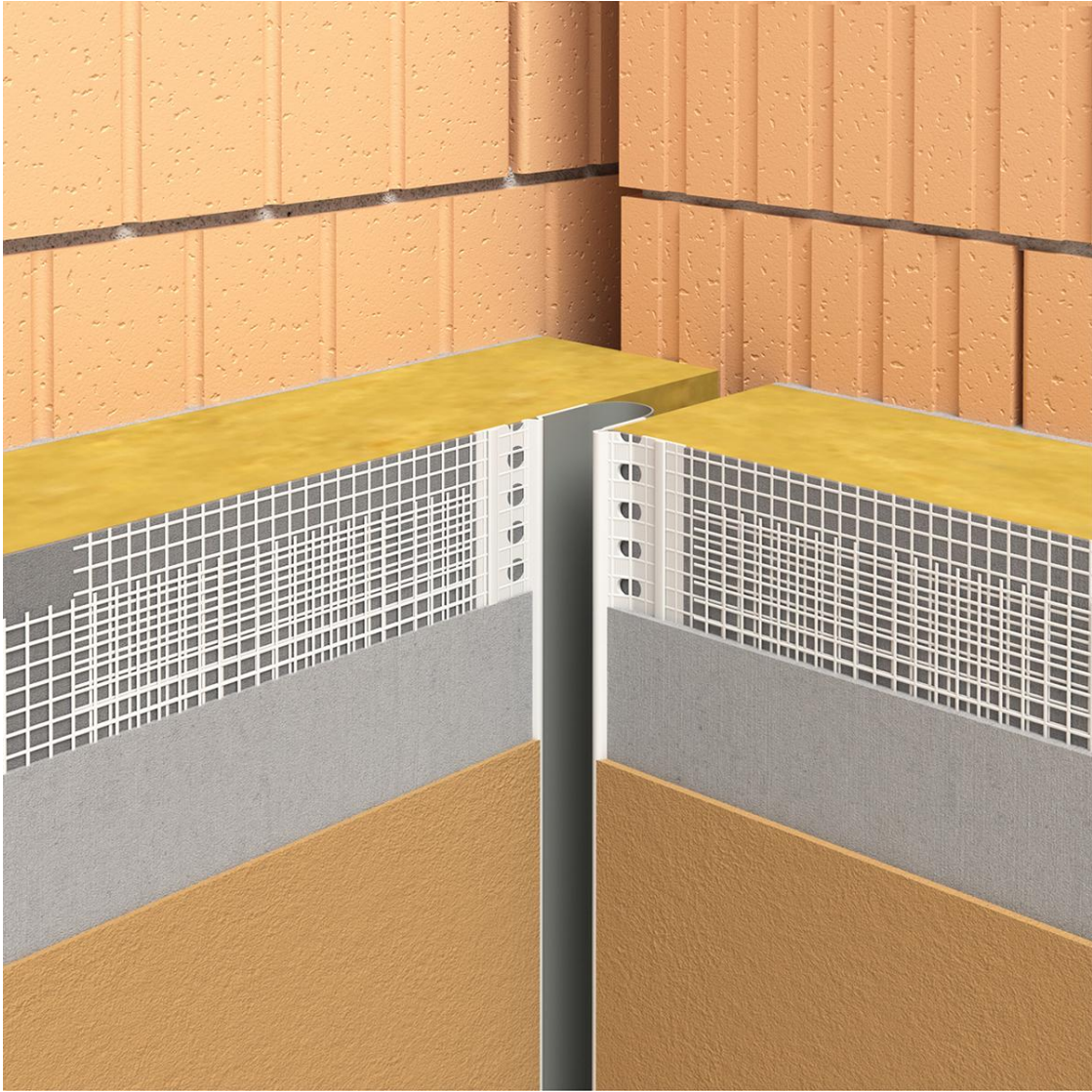

001